

CAST-IN-PLACE

Concrete Homes

With Reusable Aluminum Forms

Solid Concrete Construction • Superior Resistance • Energy Efficient • Affordable



Western Forms



**Western
Forms**

Forming Concrete Homes
and Relationships

...That Last

www.westernforms.com

Benefits of Western Forms Systems

... for cast-in-place concrete.

10 Reasons Why...

Builders in over 30 Countries Have Chosen Western Forms as Their Preferred System for Over 25 Years.

1. Lightweight / Easy to Use

Western Forms aluminum forming systems are not only the lightest and the strongest in the world but also the easiest to use. 80% of the world's workforce are unskilled laborers. The setup of our forms require little training and no cranes.

2. Safest Housing Structures Worldwide

Western Forms systems create cast-in-place reinforced concrete structures proven to be the safest, most secure investment worldwide.

3. Reduced Construction Costs / Time

Western Forms systems reduce time of construction and reduce finishing trades / costs to complete projects up to 50% faster than traditional methods.

4. Complete Systems Provided

Western Forms systems are complete for exterior walls, interior walls, foundations, floor slabs, windows, doors, parapets, overhangs / balconies and optional insulation systems. All system options are "integrated" into one system and poured "monolithically" in a daily cycle. So you can build one house or apartment per day. This includes walls and ceilings.

5. Safe Investment with Quick Return

Western Forms systems have been used by contractors and builders in the USA for over 50 years and in over 30 countries for more than 25 years. An investment in Western Forms is safe and typically delivers a full return on investment in less than 24 months.

6. Best Professional Services

Western Forms system users receive the best professional services available.

- Structure / project cost comparisons
- Cycle time / labor estimates
- Form layout (CAD) services
- Custom structure features included with system
- On site field training
- New project "reconfiguration"
- On-going technical support for life of system

7. One House Per Day

Our aluminum forming systems offer features unlike any other to produce the fastest poured concrete structures. Western Forms system users typically cycle one housing unit every day with smaller crews than any other forming system.

8. 2000+ Pours

Western Forms systems are designed and manufactured with a 50 year history. They can be used to produce more than 2,000 units in their 10 year+ lifespan. Some customers get more than 3,000 uses!

9. Modular, Adaptable Systems

Western Forms systems are modular and adaptable to hundreds of designs in low rise, mid rise and high rise projects.

10. Financing Options

Western Forms systems are supplied to builders with the availability of convenient financing options typically ranging from 6-36 months.



Your Forming Solutions...

Low Rise



Mid Rise



High Rise



Structures Around the World

Argentina • Belize • Bolivia • Brazil • Canada • Chile • Colombia • Costa Rica
Dominican Republic • Ecuador • Egypt • El Salvador
Guatemala • Honduras • Ireland • Jamaica • Japan • Kuwait • Malaysia



- Engineering assistance with project development
- Full advantage of cast-in-place concrete
- Customized, on-site technical support
- 2000 to 3000 pours – Per set
- Innovative hardware options
- Consistent smooth or textured wall finishes

Low to Multi-Story Housing

Mexico • Nicaragua • Panama • Philippines • Puerto Rico
St. Martin • St. Thomas • St. John • Taiwan • Thailand • Trinidad & Tobago
USA • Ukraine • Venezuela



- Lightweight panels – weighing less than 40kg (900 mm x 2400 mm)
- Versatility - Adaptable to most architectural designs
- Industry Expertise
- Increased profits – long term investment
- Hand-set ease
- Cost savings of 10% to 30% compared to masonry

Flexible design Fast construction

Construction Sequence

Step 1: Pour Slab with Stub Utilities



Step 2: Install Rebar and Utilities



Step 3: Set Wall Forms



Step 4: Set Ceiling/Roof Forms & Utilities



Step 5: Pour Walls & Ceiling/Roof



Step 6: Strip Forms



How to get started

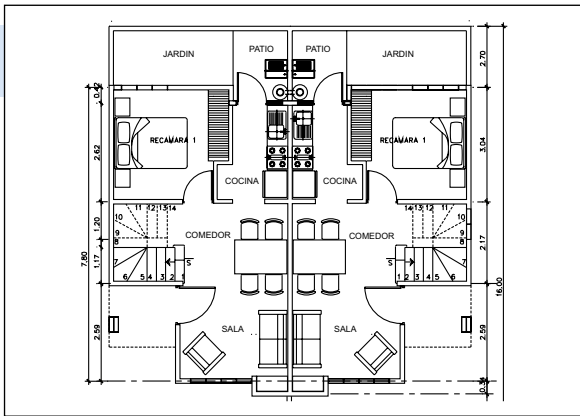

1. Send Western Forms Your Blueprints

- Select a project for consideration of Cast-In-Place construction using Removable Concrete Forms.
- Contact your Western Forms representative at the listing on the back of this brochure.



2. Evaluate & Layout Formwork

- The Western Forms design and technical team will evaluate your project and consult with you to develop a solution that meets your quality, cycle time, and final budget requirements.



3. Review System Proposal & Recommendations

- Our representative will review the forming system alternatives, costs, and benefits with you.
- Western Forms offers a variety of equipment and financing options tailored to your needs.



4. Build with Poured Concrete Technology

- A complete Western Forms system can be manufactured and on your job site in a matter of weeks.
- When your equipment arrives, so do our technicians to immediately assist your team.

Choose Western Forms As Your

Project Partner

For Cost Effective Building Solutions

In more than 30 countries around the world, Western Forms aluminum forming systems are hard at work helping contractors and developers efficiently build strong, safe, high quality homes.

We work closely with you to ensure your specifications and product selections help you build reliable, and cost-effective structures. With more than 50 years of innovative product development, we've designed our systems to ensure your mass production projects can run smoothly with reduced training costs.

From low-cost social housing to upscale apartment buildings and a wide variety of commercial applications, we have the products and the experience required for your next project. The experts at Western Forms are dedicated to helping your projects and your business succeed.

When you do business with Western Forms, you'll discover you are not simply investing in a product, you are gaining a partner.



www.westernforms.com
6200 Equitable Road
Kansas City, MO 64120
816-241-0477
info@westernforms.com